

ZX4500A/ZX5000A Parts List

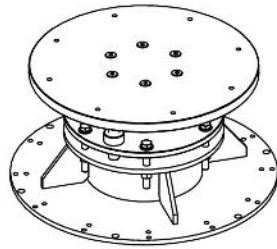

①

Center Bearing
×1 pc

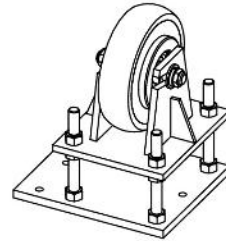

②

Support Wheel
×12 pcs

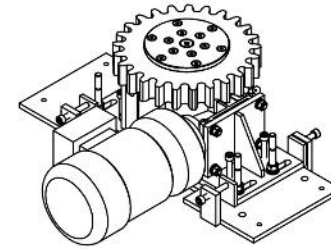

③

Motor Drive
×1 pc



④

Angle Steel Type 1
×10 pcs



⑤

Angle Steel Type 2
×1 pc



⑥

Angle Steel Type 3
×1 pc

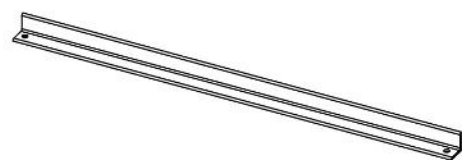

⑦

Angle Steel Type 4
×11 pcs

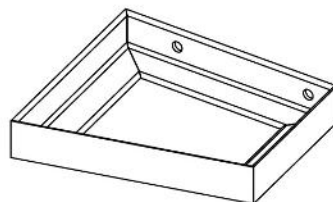

⑧

Motor Drive Connecting Structure
Type 1
×1 pc

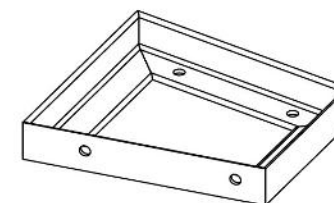

⑨

Motor Drive Connecting Structure
Type 2
×1 pc

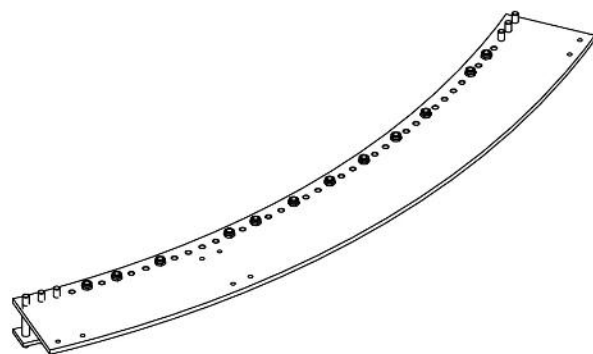

⑩

Rail Plate Device
×8 pcs
with numbers (1~8)

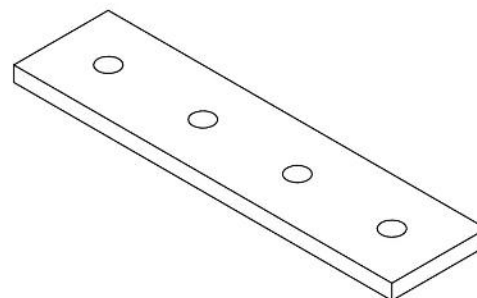

⑪

Rail Connecting Plate
×8 pcs

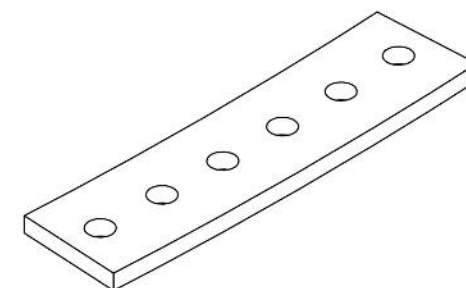

⑫

Mount Connecting Plate
×16 pcs

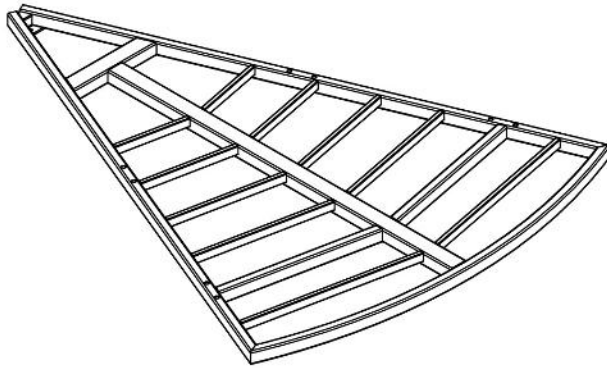

⑬

Steelworks
×8 pcs
with numbers (1~8)

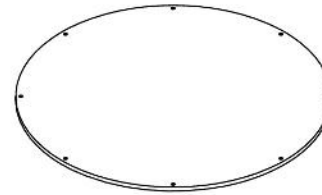

⑭

Center Top
×1 pc
one hole with number 1

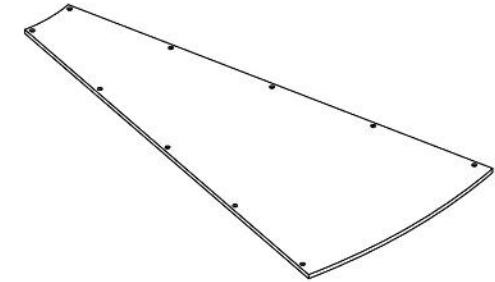

⑮

Top Surface
×16 pcs
with numbers (1~16)

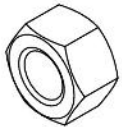

⑯

Hexagon Nuts
M10
×4 pcs



⑰

Hexagon Socket Head Cap Screws
M10×20
×32 pcs



⑱

Hexagon Socket Head Cap Screws
M10×16
×106 pcs

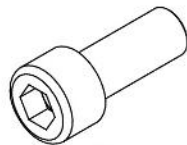

⑲

Hexagon Socket Head Cap Screws
M10×25
×12 pcs



⑳

Spring Washers
10
×118 pcs



㉑

**Hexagon Socket Flat
Countersunk Head Cap Screws**
M8×16
×168 pcs



㉒

Nylon Lock Nuts
M12
×96 pcs

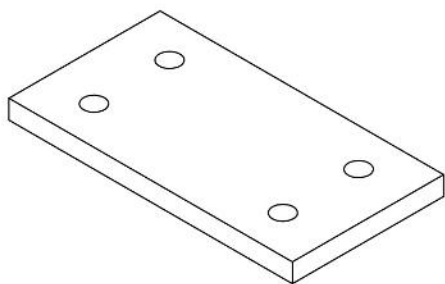

23

Supporting Plate
×8 pcs



24

Nylon Lock Nuts
M10
×32 pcs



25

Flat Washers
10
×32 pcs



26

Hexagon Socket
Head Cap Screws
M10×30
×32 pcs

ZX4500A/ZX5000A Installation Guide

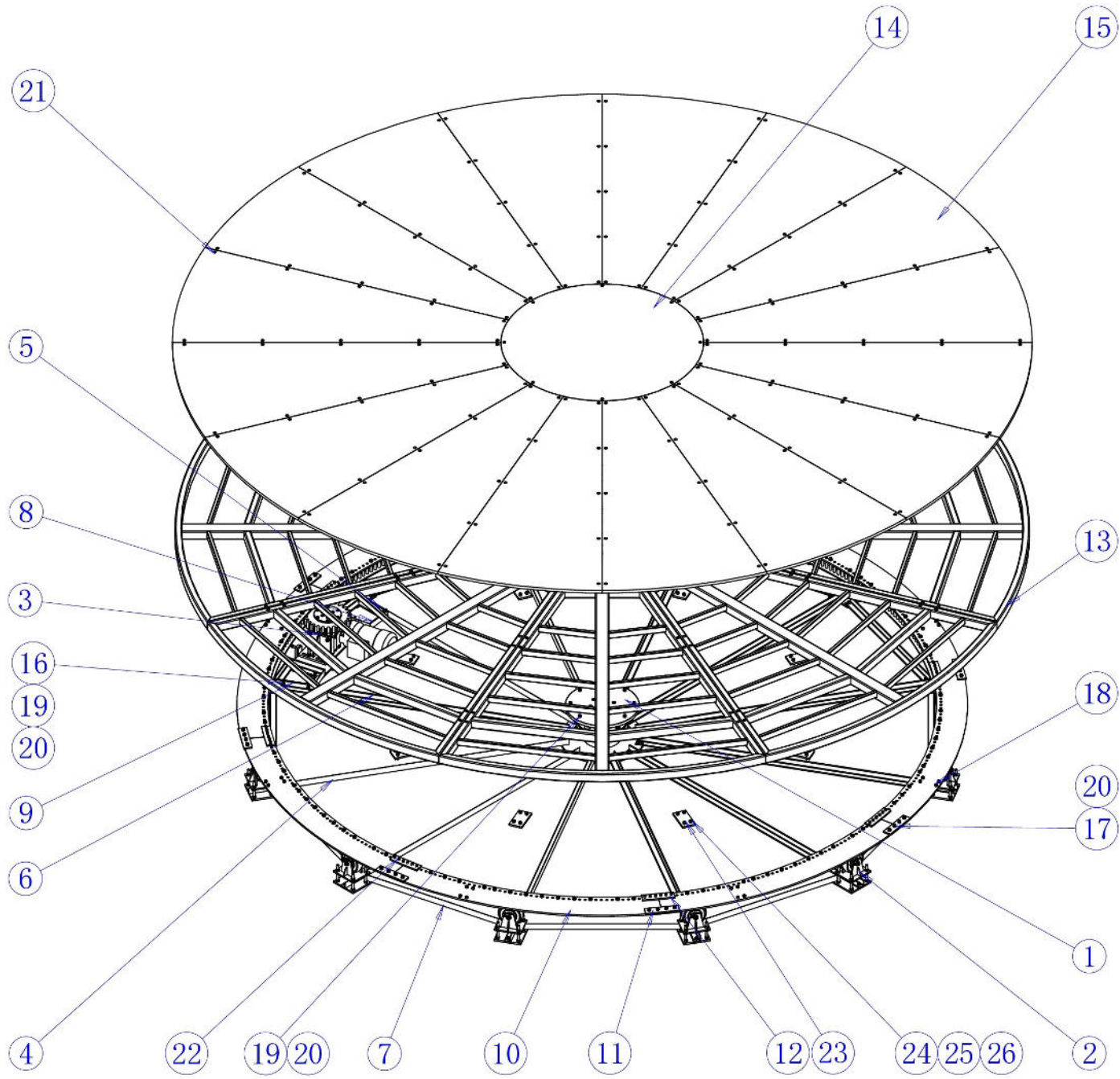

No.	Item Name
①	Center Bearing
②	Support Wheel
③	Motor Drive
④	Angle Steel Type 1
⑤	Angle Steel Type 2
⑥	Angle Steel Type 3
⑦	Angle Steel Type 4
⑧	Motor drive Connecting Structure Type 1
⑨	Motor drive Connecting Structure Type 2
⑩	Rail Plate Device
⑪	Rail Connecting Plate
⑫	Mount Connecting Plate
⑬	Steelworks
⑭	Center Top
⑮	Top Surface
⑯	Hexagon Nuts
⑰	Hexagon Socket Head Cap Screws
⑱	Hexagon Socket Head Cap Screws
⑲	Hexagon Socket Head Cap Screws
⑳	Spring Washers
㉑	Hexagon Socket Flat Countersunk Head Cap Screws
㉒	Nylon Lock Nuts
㉓	Supporting Plate
㉔	Nylon Lock Nuts
㉕	Flat Washers
㉖	Hexagon Socket Head Cap Screws

Step 1

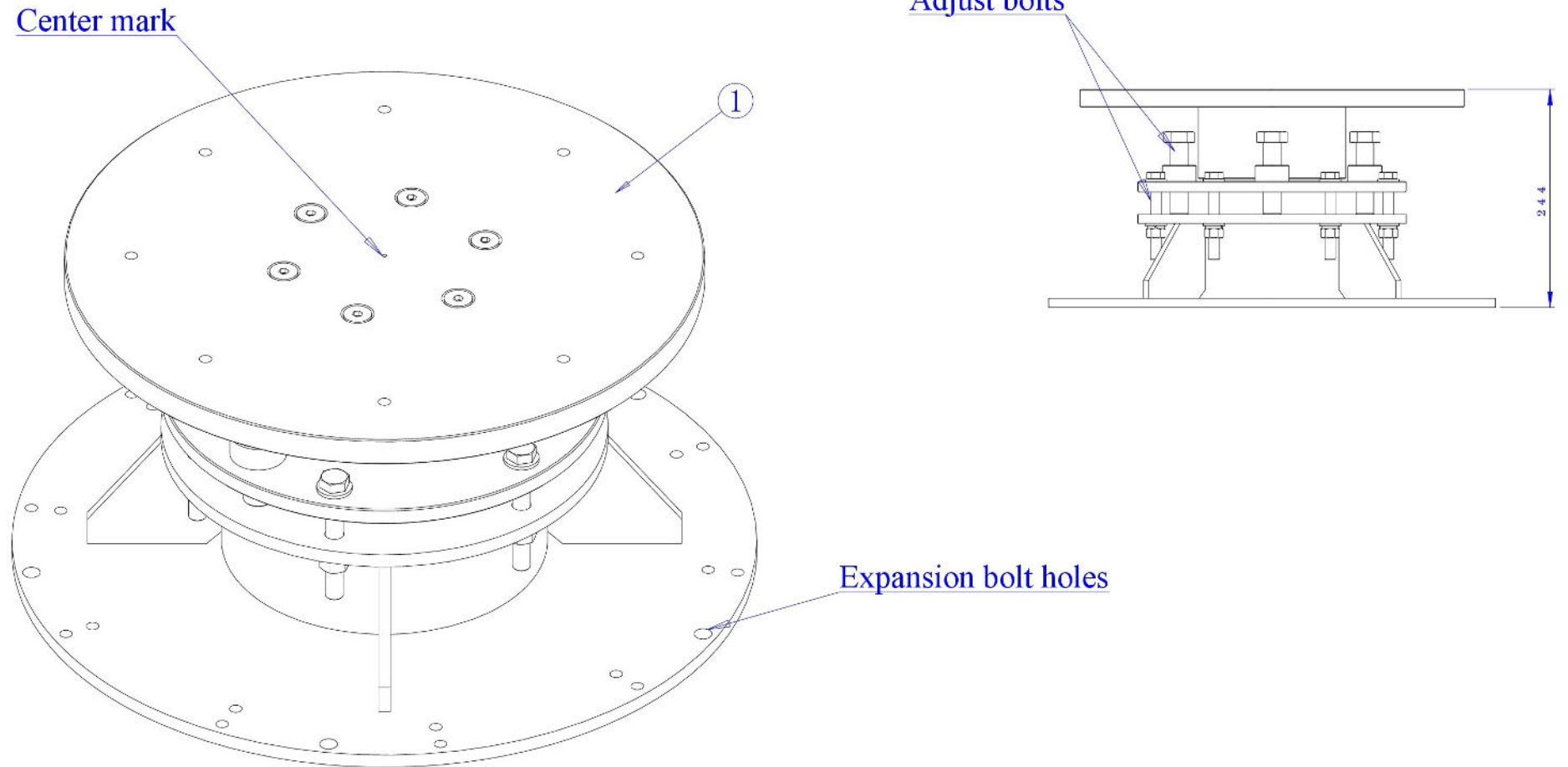

1. Identify the center of the turntable. Place ① and adjust the height to 244mm;
2. Fix it on the ground by M8 X 80 expansion bolts (see appendix II).

Step 2

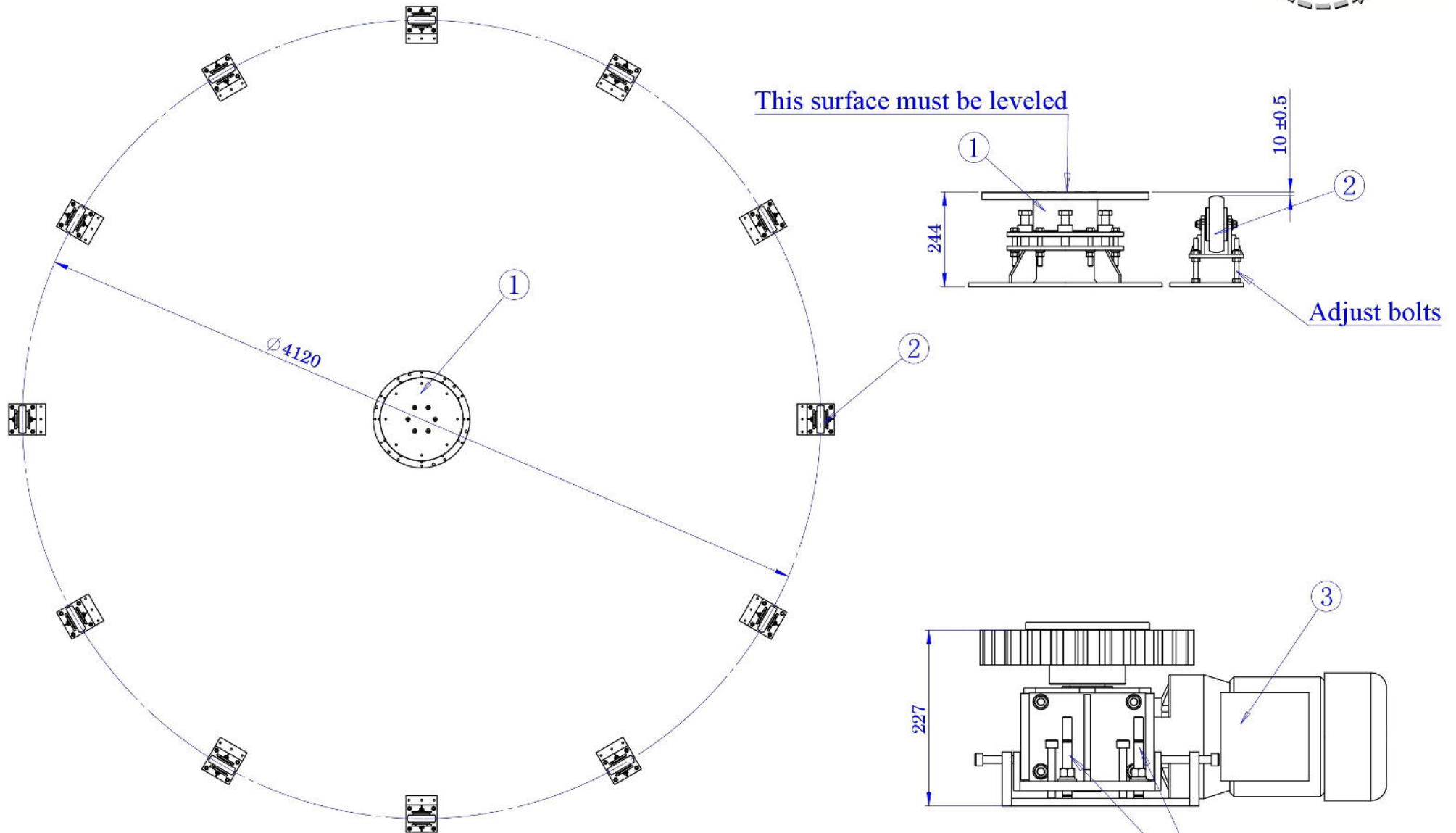

1. Adjust the bolts and make the surface of ① be leveled (see appendix III);
2. Adjust the height of ② and make the height of wheel is 10 ± 0.5 mm below ① (see appendix IV).

Step 3

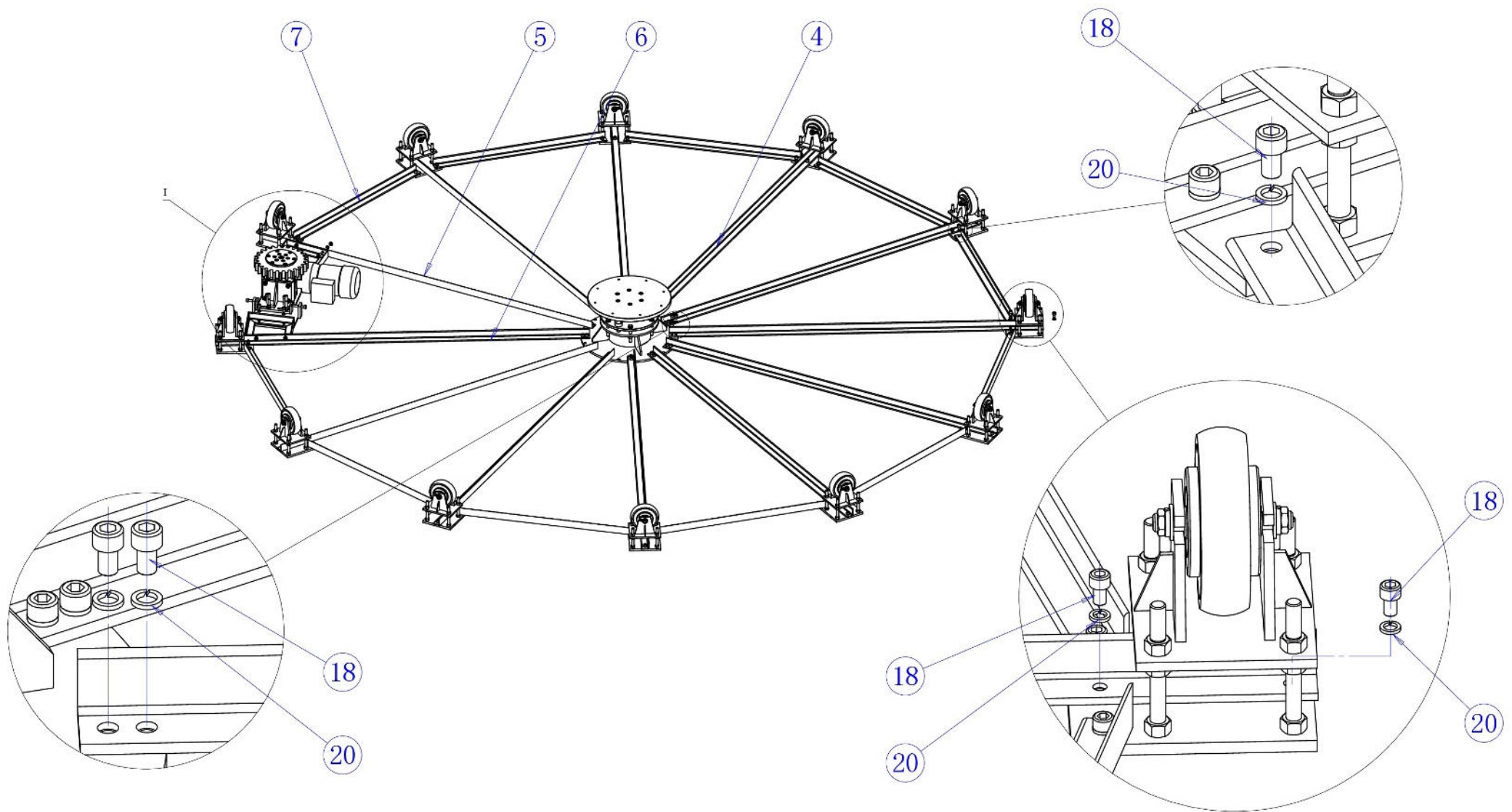

Connect ④, ⑤, ⑥, ⑦ as picture, and fasten ⑱.

Step 4

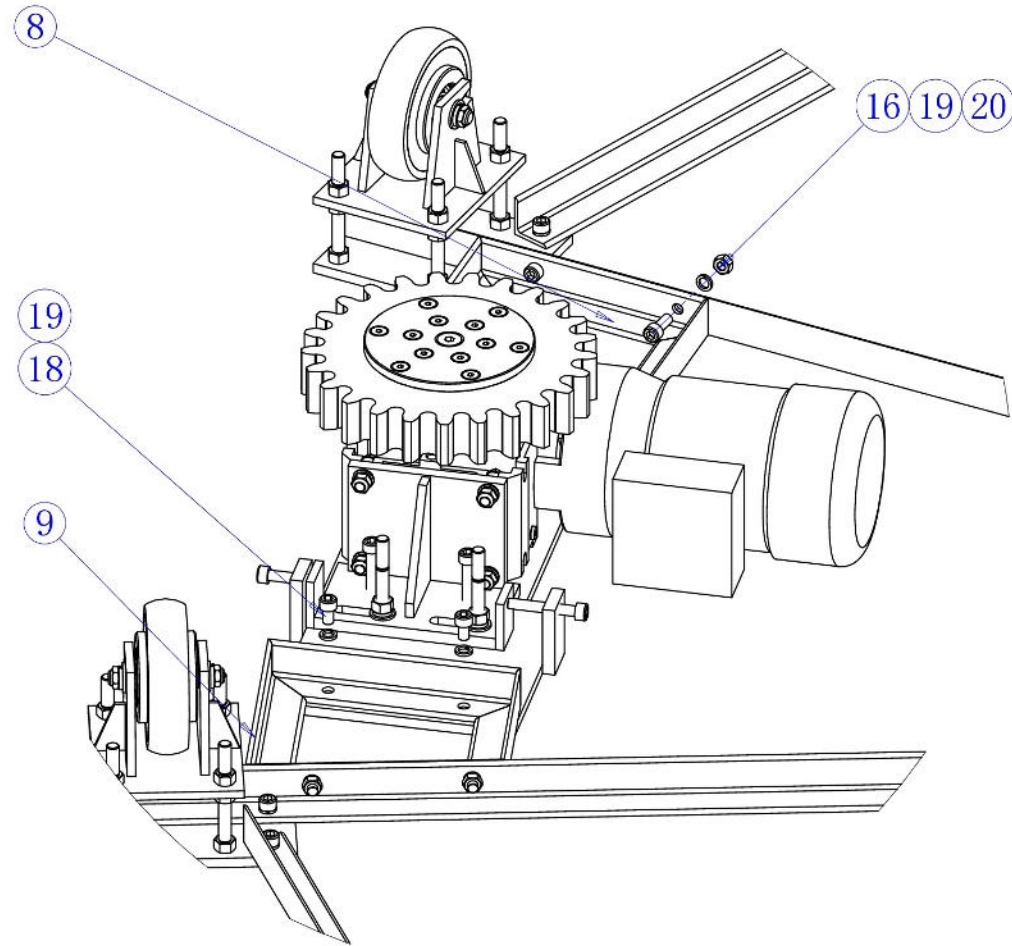

Connect ⑧, ⑨.

Step 5

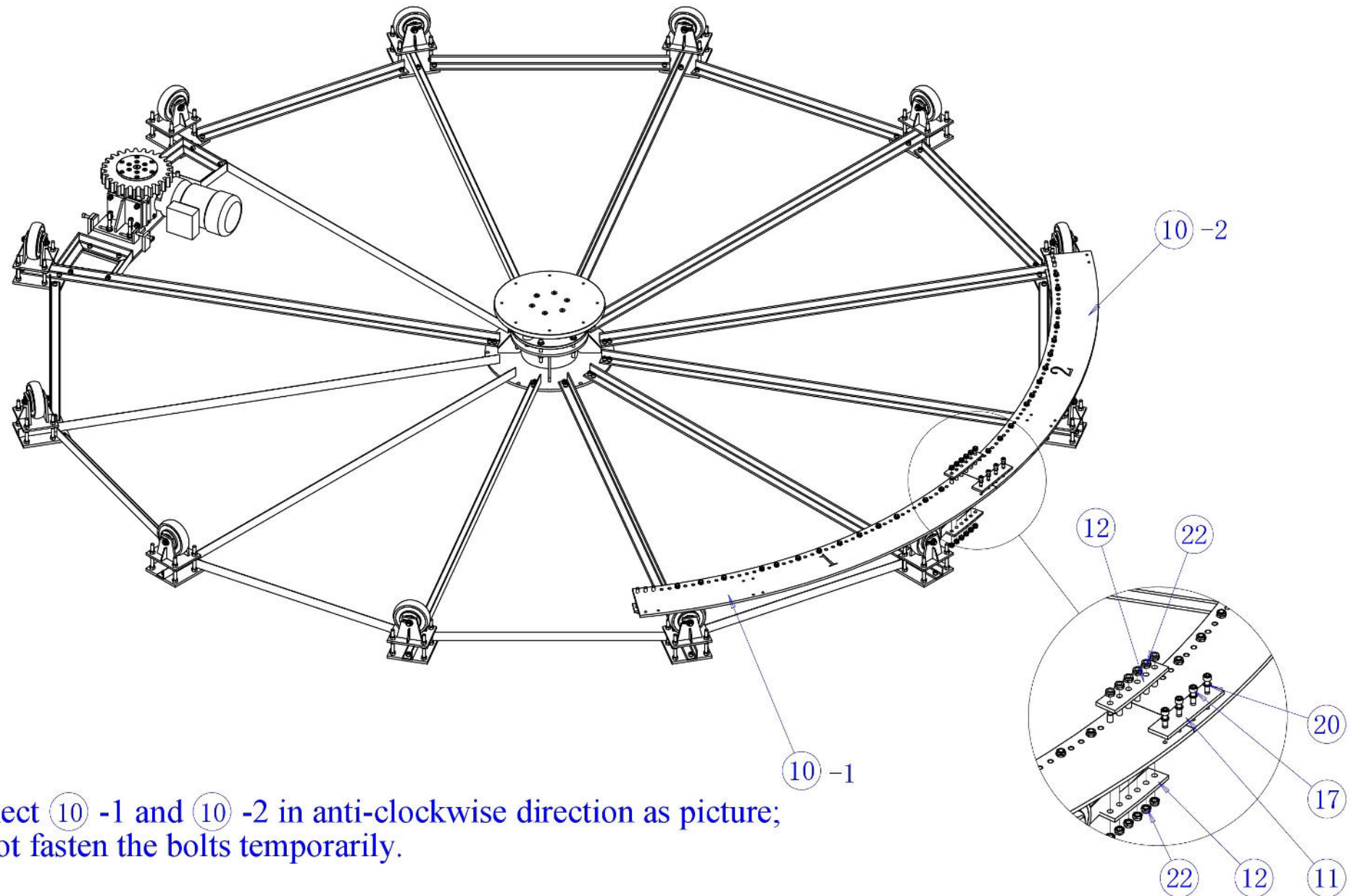

1. Connect ⑩ -1 and ⑩ -2 in anti-clockwise direction as picture;
2. Do not fasten the bolts temporarily.

Step 6

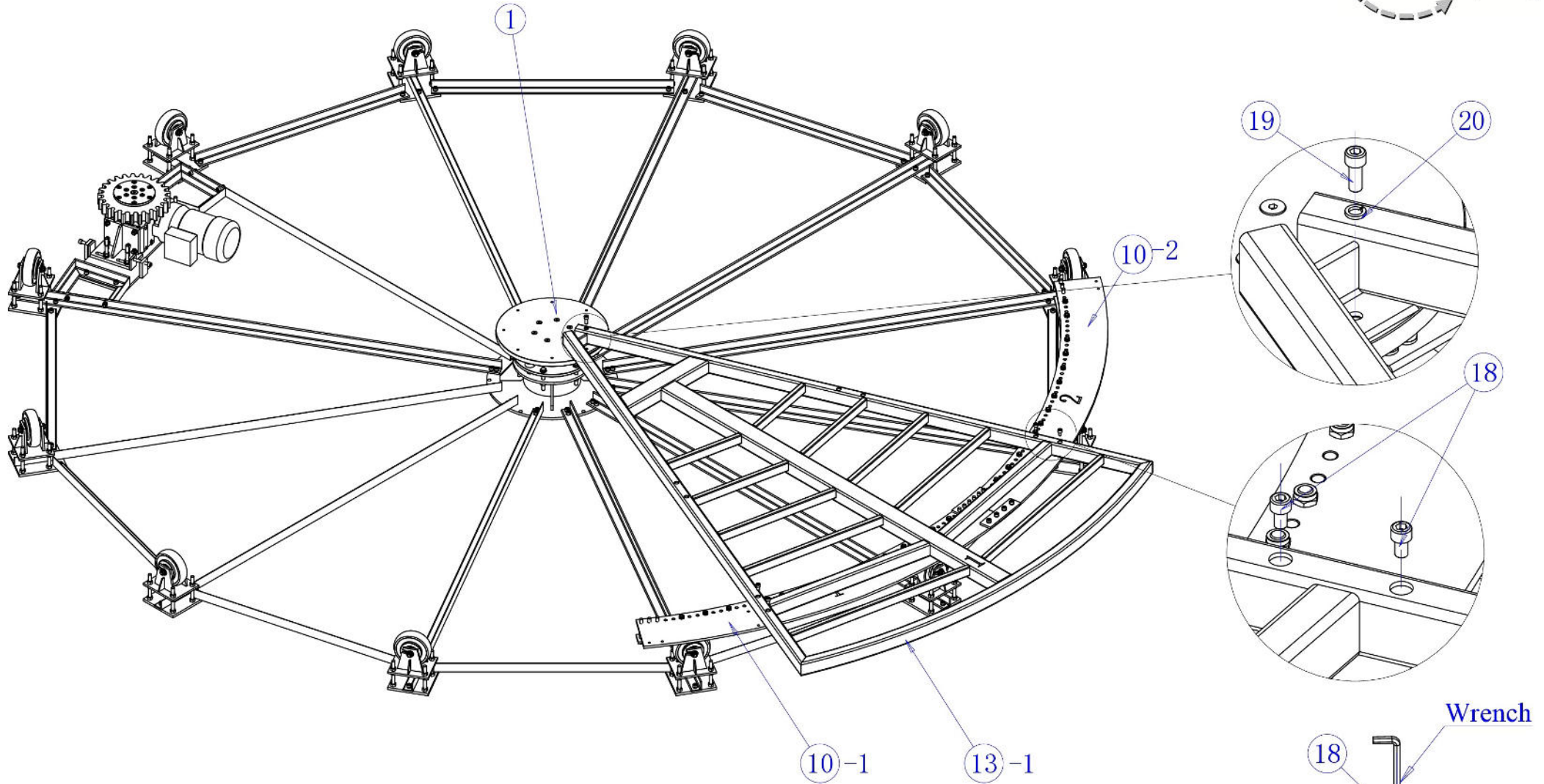

1. Place (13) -1 on (10) -1 and (10) -2, the position of (13) -1 is corresponding to mark 1 of (1) as picture;
2. Use supplied sleeve to connect (18) to the screw thread of (10) ;
3. Use (19) , (20) to connect (1) , (13) ;
4. Do not fasten standard parts temporarily.

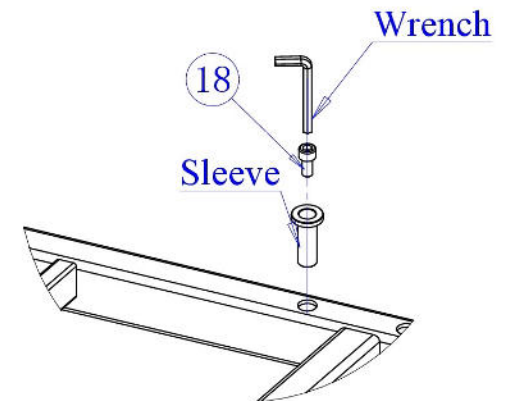

Step 7

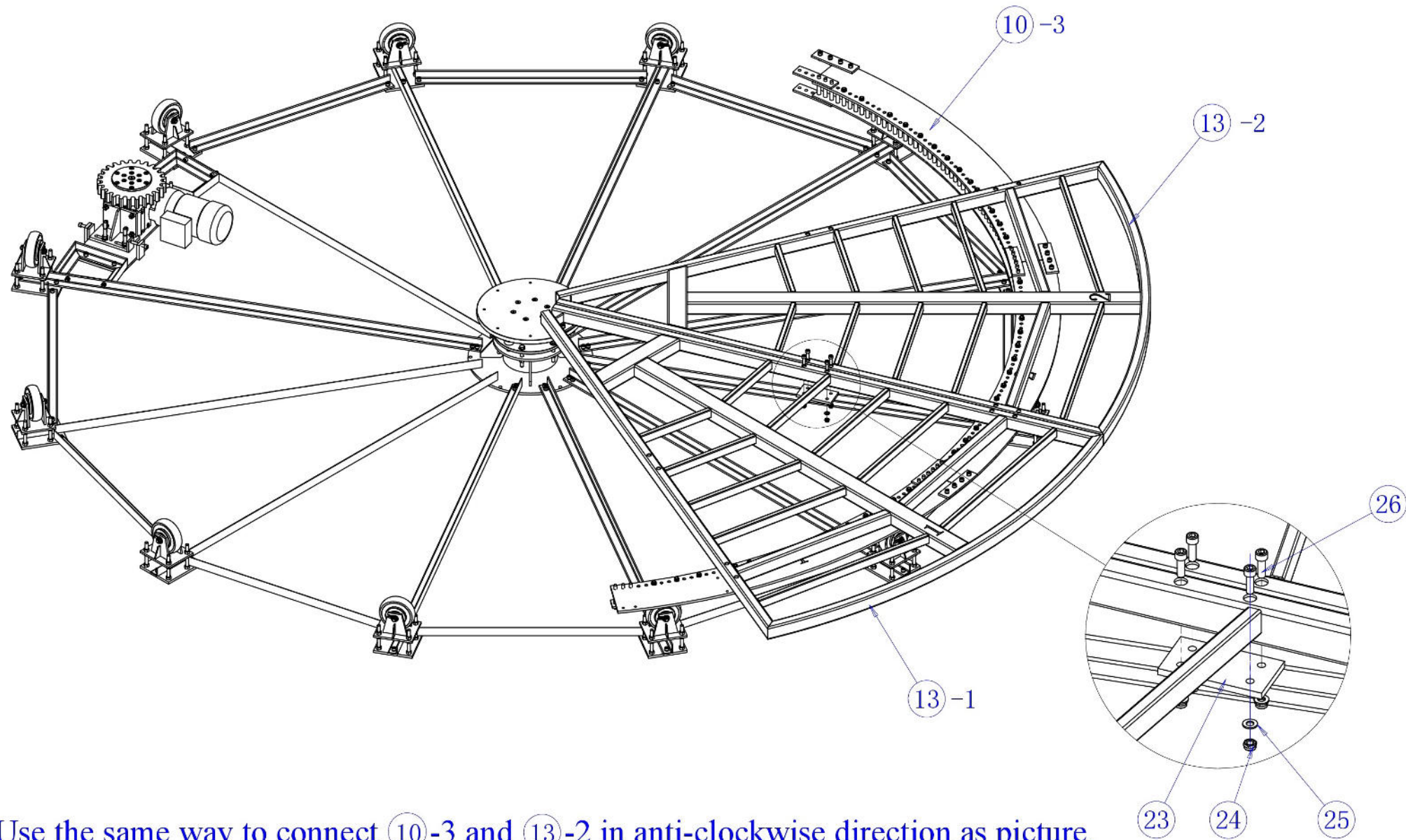

Use the same way to connect ⑩-3 and ⑬-2 in anti-clockwise direction as picture.

Step 8

The distance between the root of the gear and pin is 1.5~3.0mm

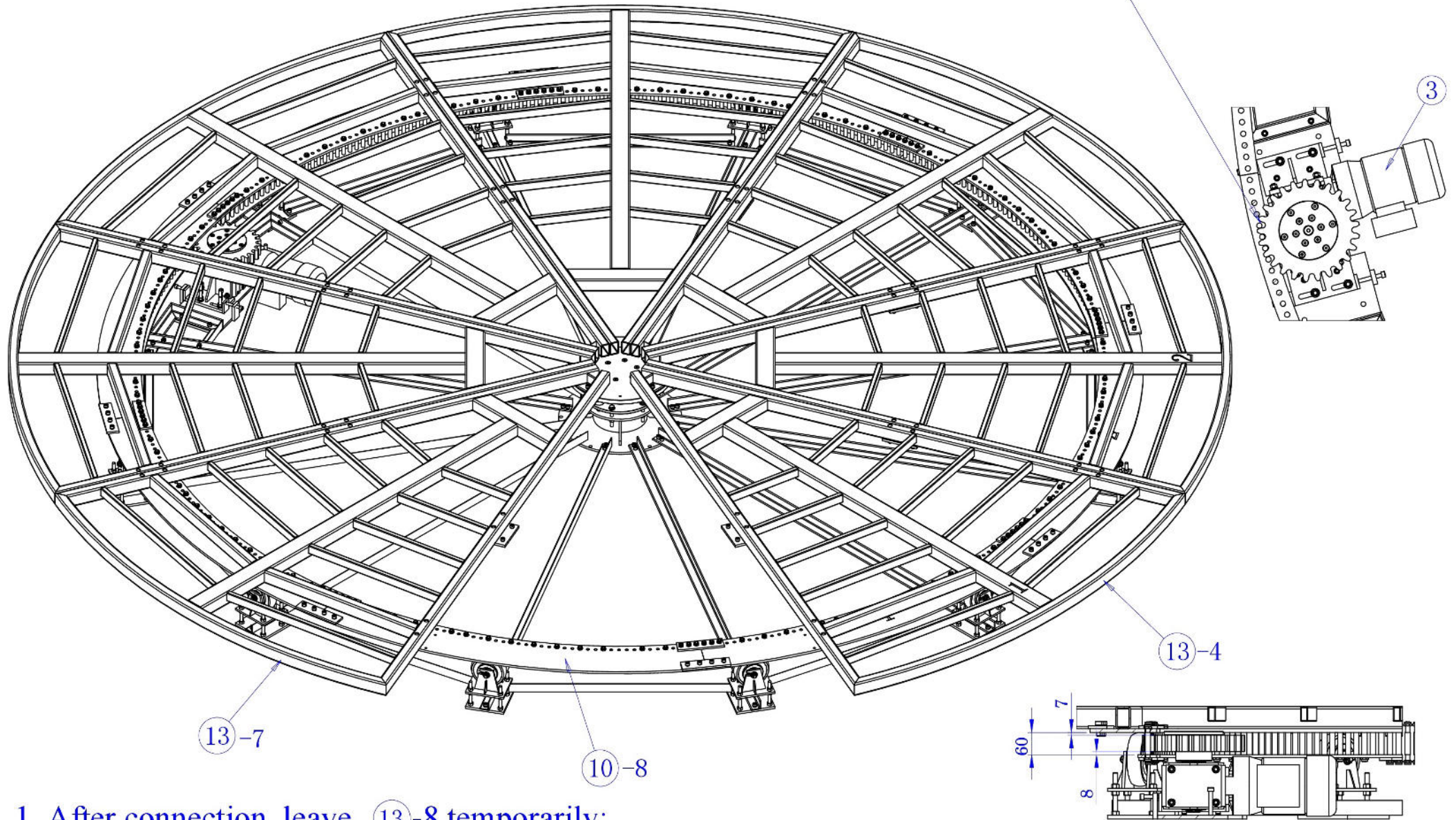

1. After connection, leave ⑬-8 temporarily;
2. Adjust the height and position of ③, make gear and pin mesh accurately (see appendix V and VI);
3. Follow "Control Box Wiring Diagram" to do the wiring. Power on and test.

Step 9

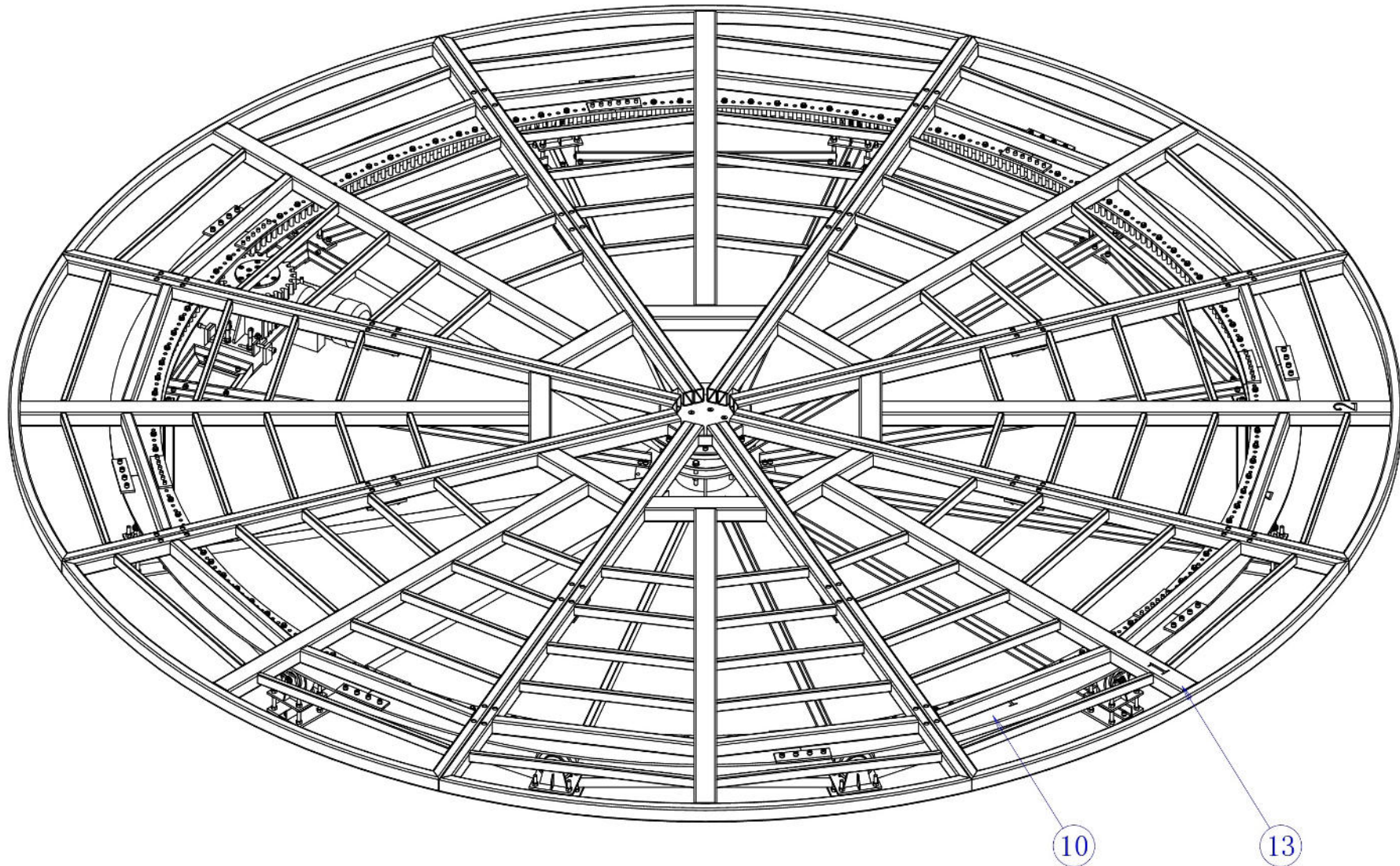

1. If the turntable runs in normal condition, fasten all ⑩ and ⑬;
2. Apply supplied grease at the position that driving gear and pin fits;
3. Apply supplied grease at the position that support wheel body and rail plate contacts.

Step 10

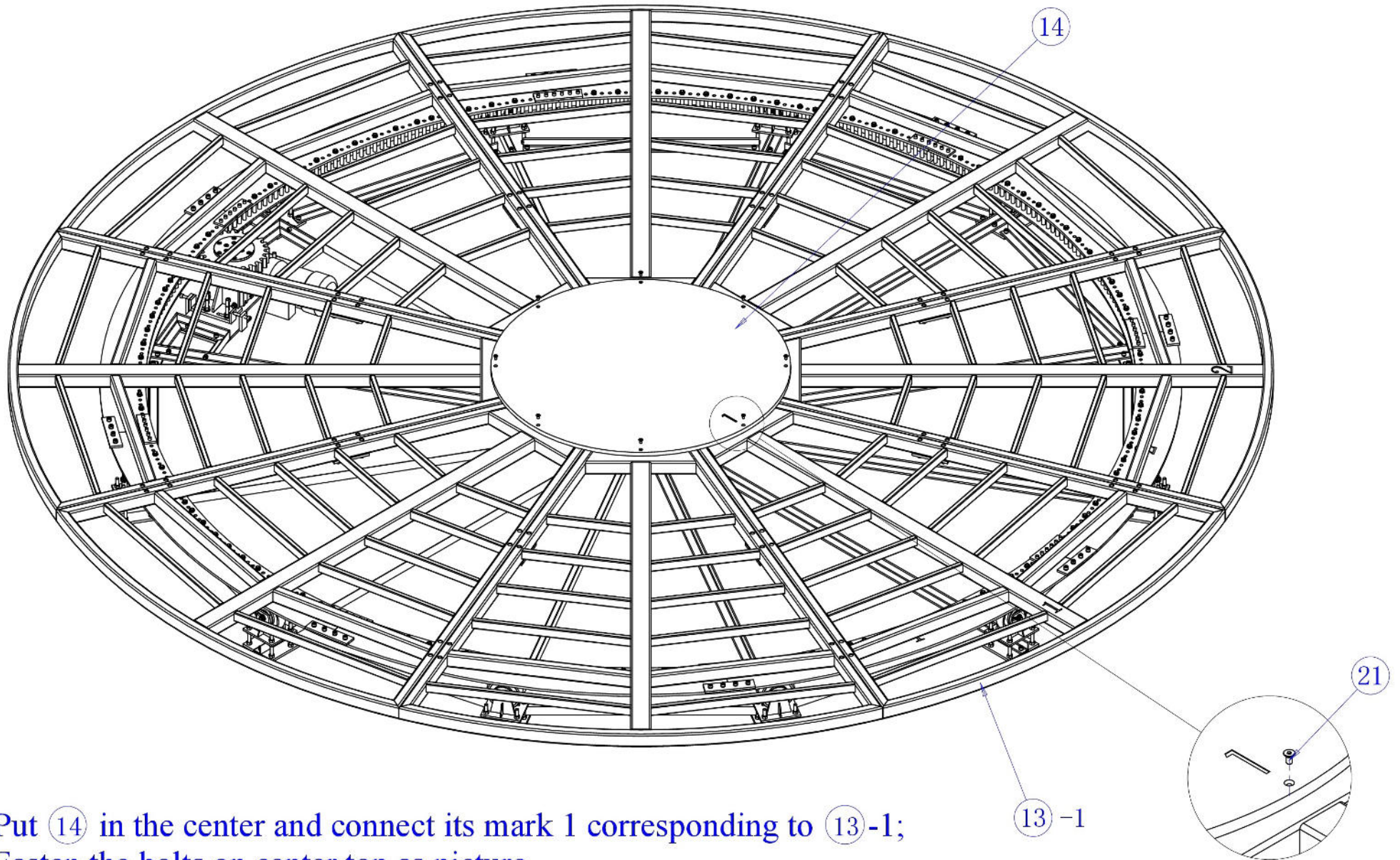

1. Put ⑭ in the center and connect its mark 1 corresponding to ⑬-1;
2. Fasten the bolts on center top as picture.

Step 11

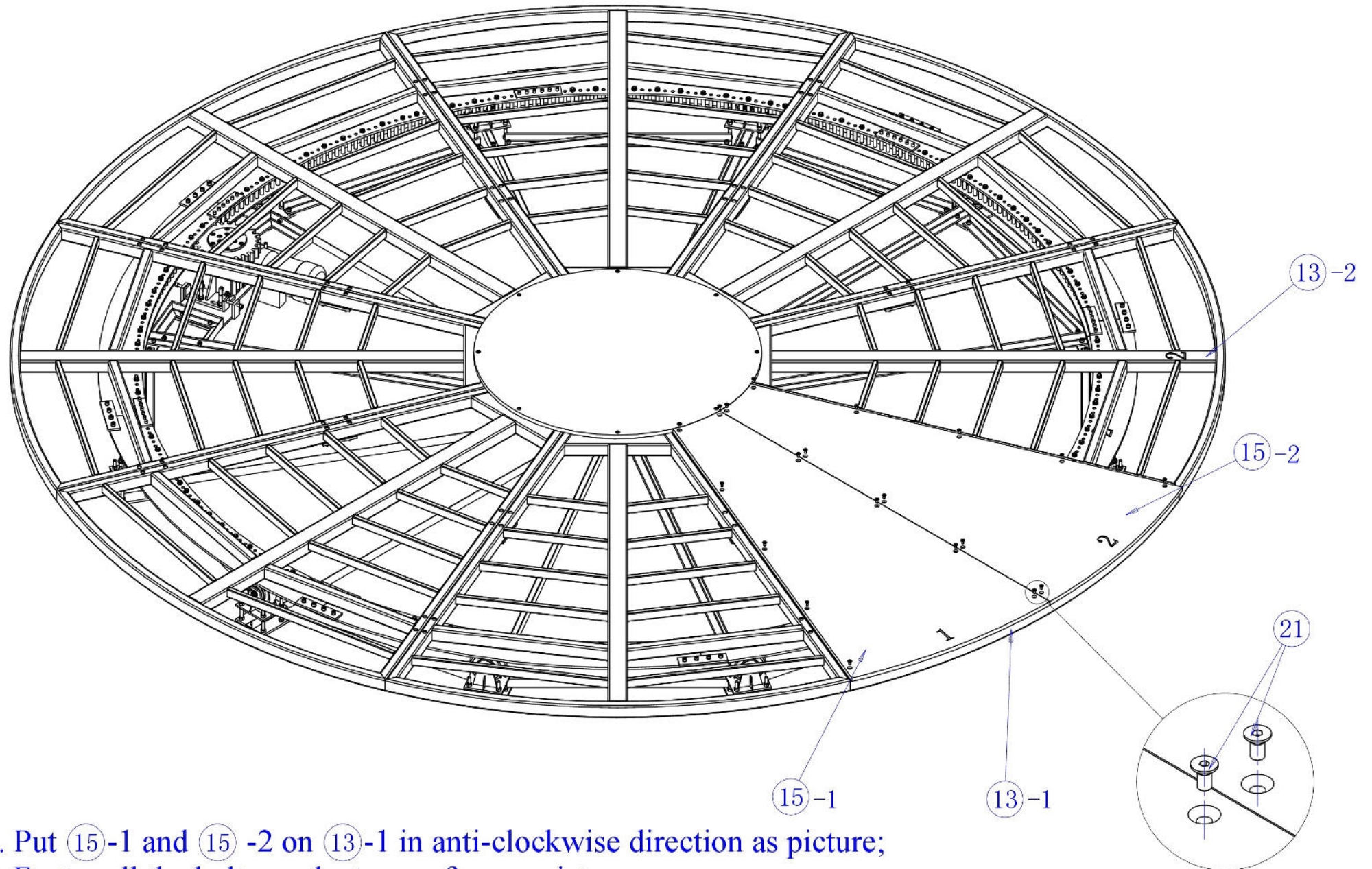

1. Put 15-1 and 15-2 on 13-1 in anti-clockwise direction as picture;
2. Fasten all the bolts on the top surface as picture.

Step 12

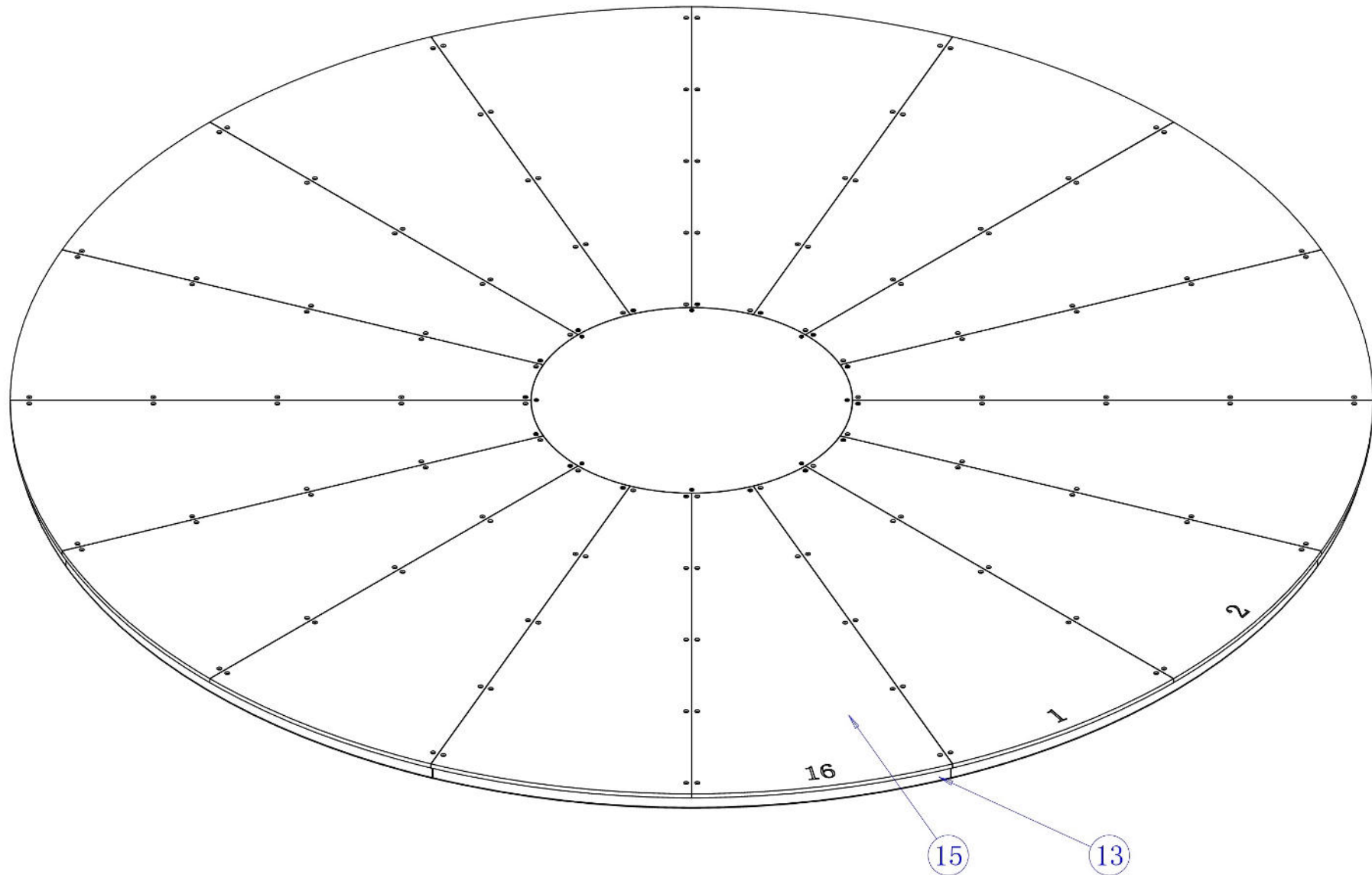

1. Put 15 on 13 in turn and fasten it by countersunk head cap screws;
2. Power on and test.

ZX4500A/ZX5000A Parts Size and Weight

No.	Item Name	Size (mm)	Weight (kg)	Standard #
1	Center bearing	500x500x244	67	①
2	Support wheel	190x160x234	8.9	②
3	Motor drive	520x620x237	45.4	③
4	Rail plate device	1626x328x115	32	⑩
5	Steelworks	2375x1591x60	74	⑬
6	Center top	1178x1178x6	17.64	⑭
7	Top surface	1910x975x6	19	⑮

Appendix II

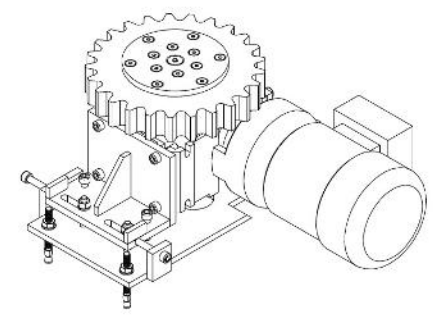
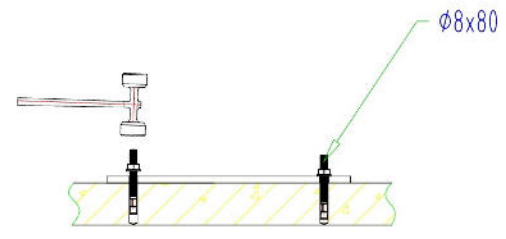
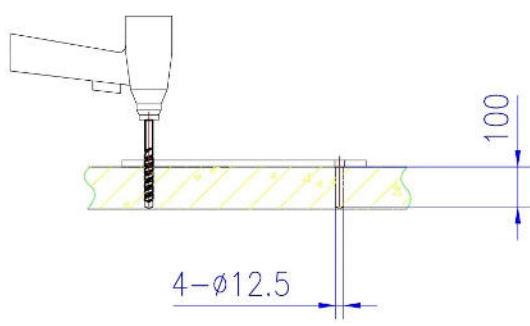
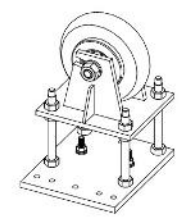
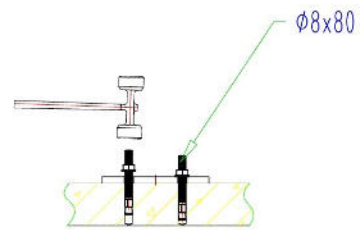
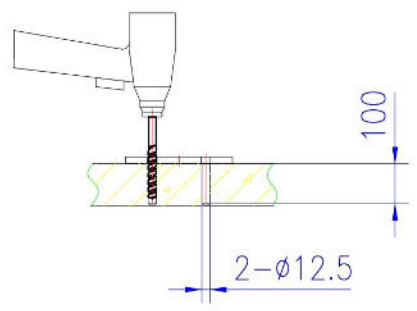
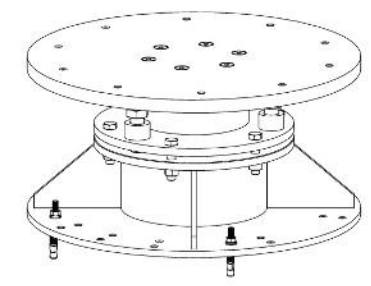
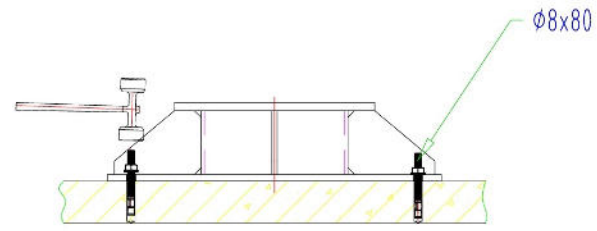
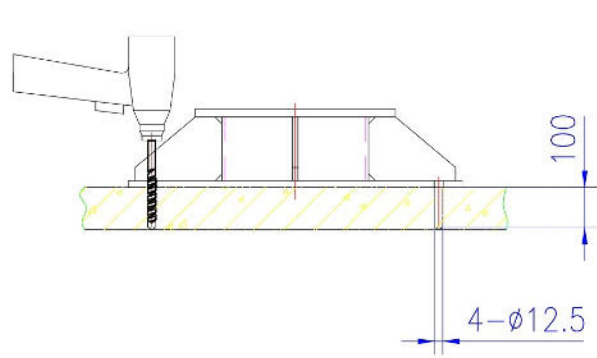

Increase the height

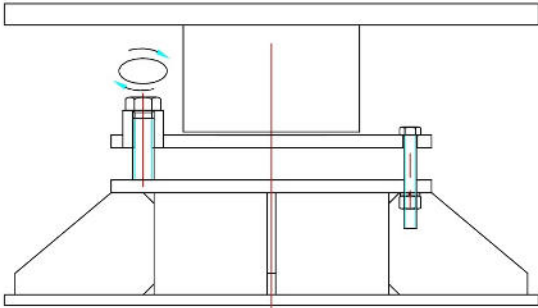
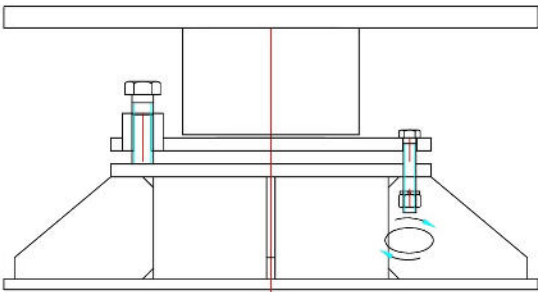

Reduce the height

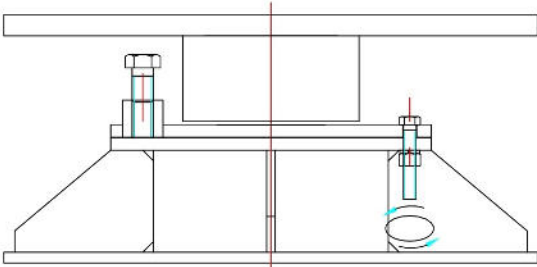
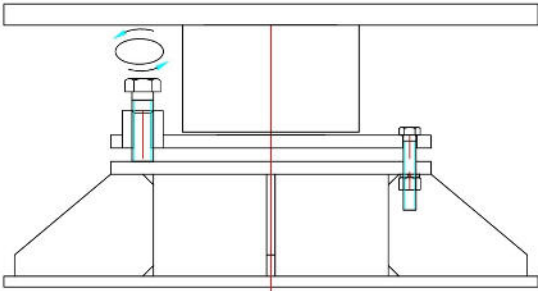

Increase the height

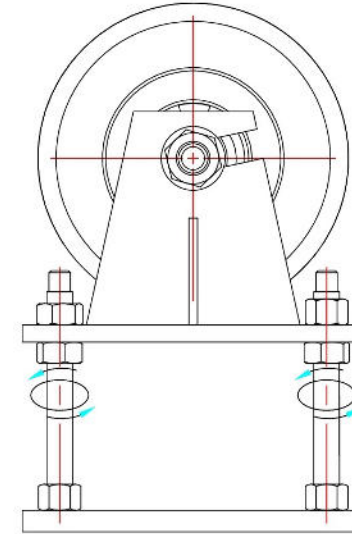
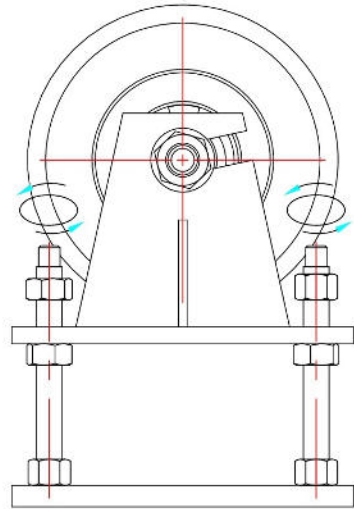

Reduce the height

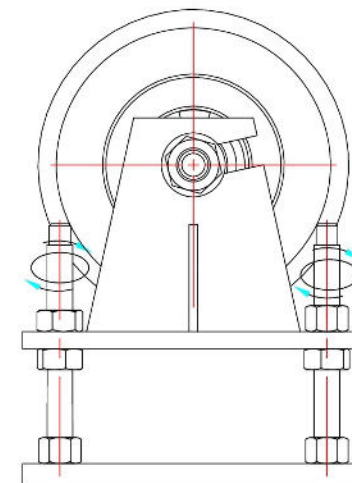
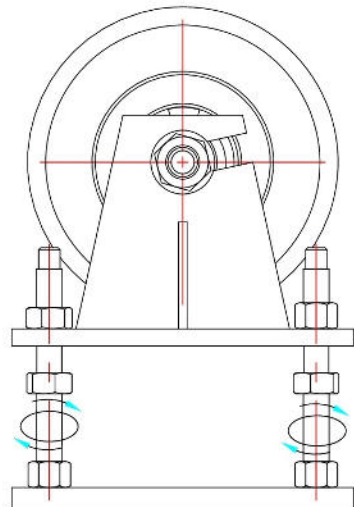

Increase the height

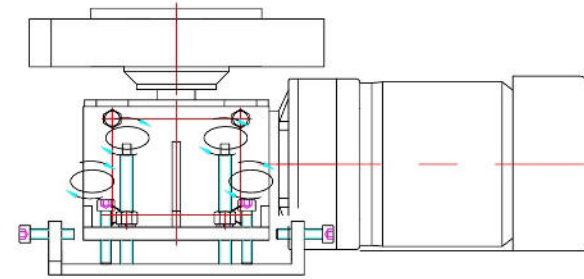
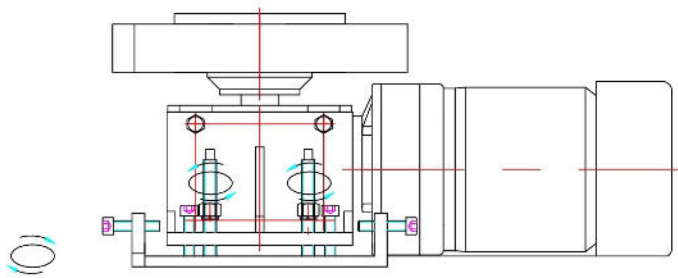

Reduce the height

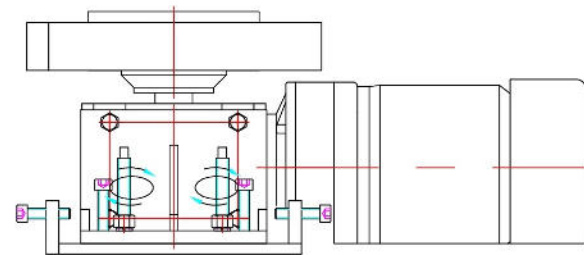
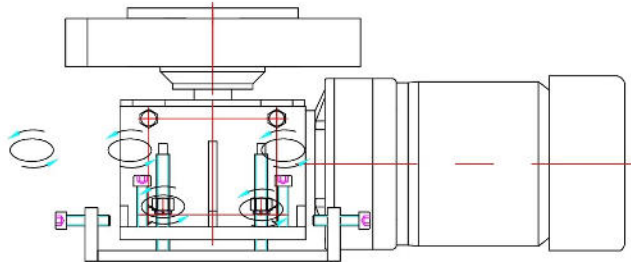

Reduce the distance between the root of the gear and pin

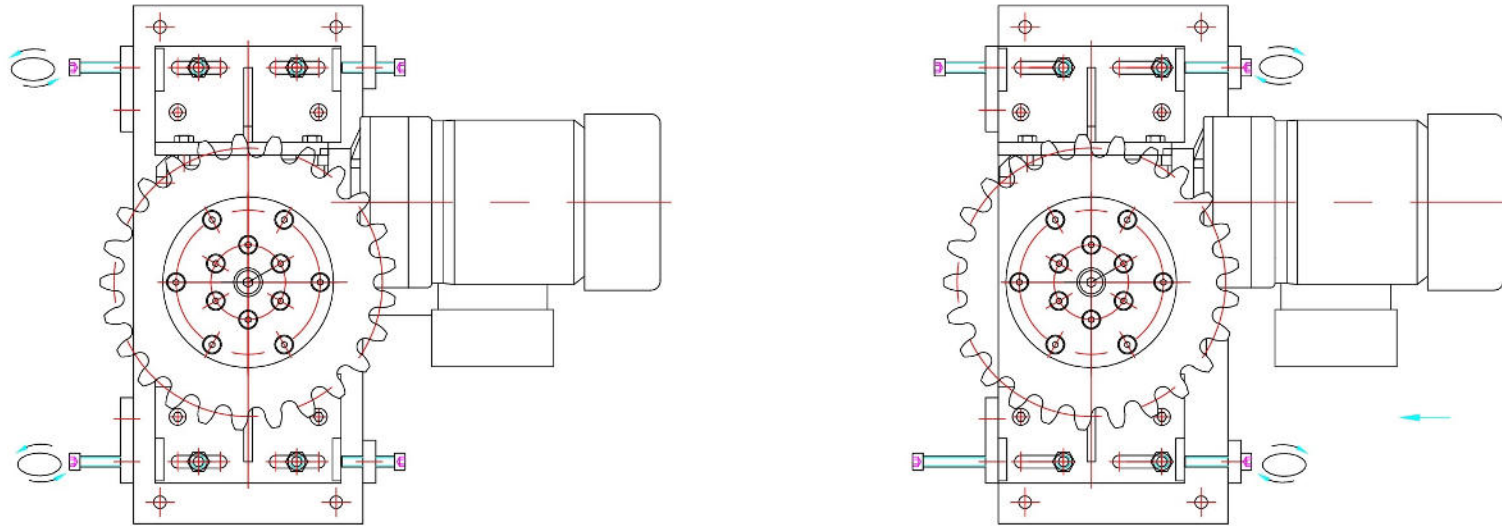

Increase the distance between the root of the gear and pin

